



**FOR  
LEASE**

Brand New Restaurant & Retail Spaces ranging from  
**727 - 4,550 square feet**

Newly Constructed Chain & Forge Building

For additional information,  
please contact our  
leasing team at  
[leasing@granvilleisland.com](mailto:leasing@granvilleisland.com)





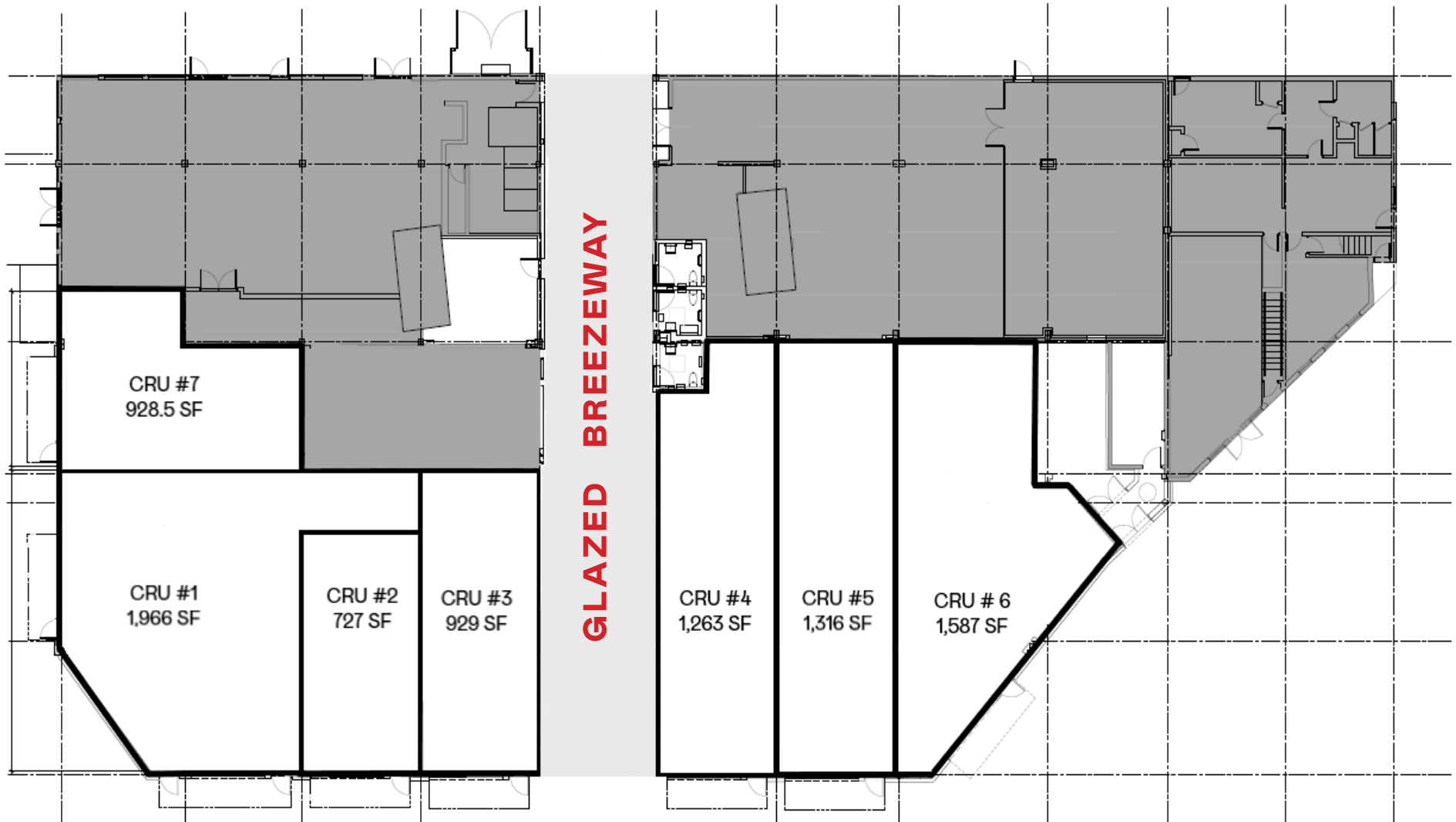

**GLAZED BREEZEWAY**

- AVAILABILITY** Ready for fixturing approximately Q4 2023
- ASKING RENT** Basic Rent - \$75.00 per rentable square foot per annum and Percentage Rent - 8% of Gross Revenue
- ADDITIONAL RENT** Estimated for 2023 - \$60.95 per rentable square foot per annum (inclusive of Water, Waste Removal & Common Area Maintenance)
- OTHER** Hydro & Gas are separately metered, Property Taxes
- VISITOR NUMBERS** Projected 10 million visitors in 2023 (Average of 34,000 a day from May-September & anticipate 23,000 a day from October-April)



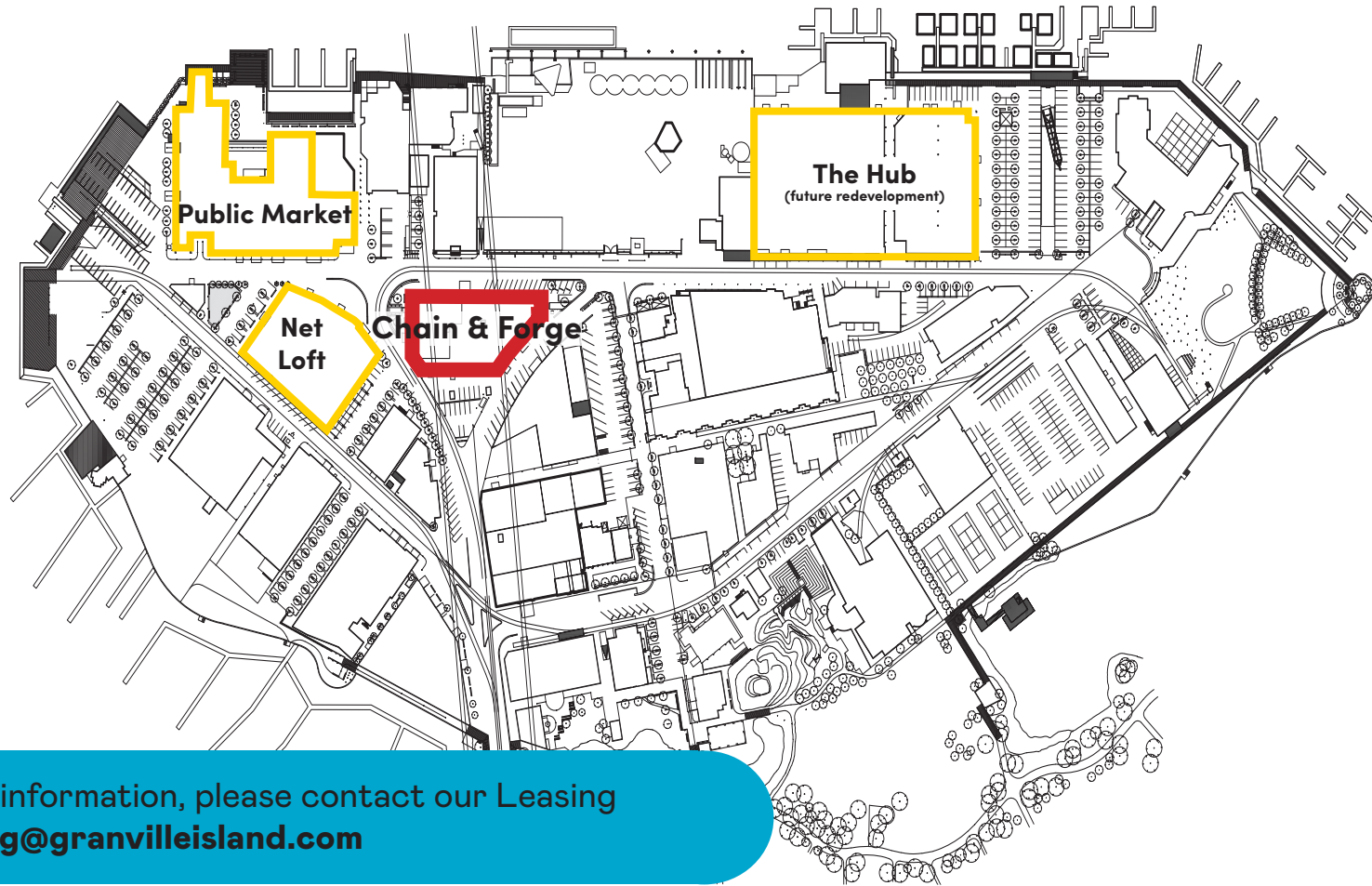

For additional information, please contact our Leasing Team at [leasing@granvilleisland.com](mailto:leasing@granvilleisland.com)







## What is the Chain & Forge?

The Chain & Forge is the first major redevelopment on Granville Island since the 1970s. Iconic in nature, it's one of the first buildings seen when driving on to the Island, framed by two towering murals designed by Musqueam artist, weaver, and knowledge keeper, Deborah Sparrow.

Located just steps from the famous Public Market, this building marks the first redevelopment in the creation of the Market District; envisioned in the Granville Island 2040: Bridging Past & Future Report as incorporating and forming an extension of the Public Market. The Market District will be a new retail destination in the City; providing a platform for inspiring and innovative businesses to thrive. With the aim of enriching night-time activities on Island, priority will be given to prospective tenants that can remain open into the evening hours.

The Chain & Forge's central location and proximity to the vibrant surrounding streetscape will be further complemented by a gathering space directly at the doorsteps of these new commercial-retail spaces. Opportunities for culinary and event programming in this gathering space are countless, creating additional draws to the building and the spaces directly adjacent to it.

Like what you see? Come be a part of this building's transformation and of the Market District's launch. If you have a new and unique concept, or if you're looking to fill a gap in the already rich and diverse set of offerings on Granville Island, make sure to apply.

